

26701 - 26707 AGOURA ROAD
CALABASAS, CA 91362

R&D/WAREHOUSE
FOR SUBLEASE

26701

MICHAEL TINGUS
President
818.223.4380
mtingus@lee-re.com
www.miketingus.com
DRE# 01013724

GRANT FULKERSON, SIOR
Principal
818.304.4956
gfulkerson@lee-re.com
www.fulkerson-re.com
DRE# 01483890

 **LEE &
ASSOCIATES**

COMMERCIAL REAL ESTATE SERVICES
No warranty or representation is made to the
accuracy of the foregoing information. Terms of
sale or lease and availability are subject to change
or withdrawal without notice. CID #01191898

26701 - 26707 AGOURA ROAD

CALABASAS, CA 91362



PROPERTY SPECIFICATIONS

Property Size:	93,286 SF
	26701 Agoura Rd (Building A) 22,116 SF
	26707 Agoura Rd (Building B) 71,170 SF
Loading:	(3) Ground Level
Clearance Height:	+/- 16 Feet
Power:	2,000 AMP / 277 480 VOLT
Parking:	3.45/1,000
Lease Rate:	Negotiable

PROPERTY HIGHLIGHTS

- Freeway Identity
- Heavy Power
- Elevator Served
- Walking Distance to Retail Amenities
- Abundant Parking
- Flexible Lease Term



26701 - 26707 AGOURA ROAD

CALABASAS, CA 91362



26701 - 26707 AGOURA ROAD

CALABASAS, CA 91362



AERIAL MAP



Lost Hills Rd

26701-26707 AGOURA RD

CALABASAS, CA

US
101

VENTURA FWY (US-101)

Agoura Rd

FLOOR PLANS

1ST FLOOR

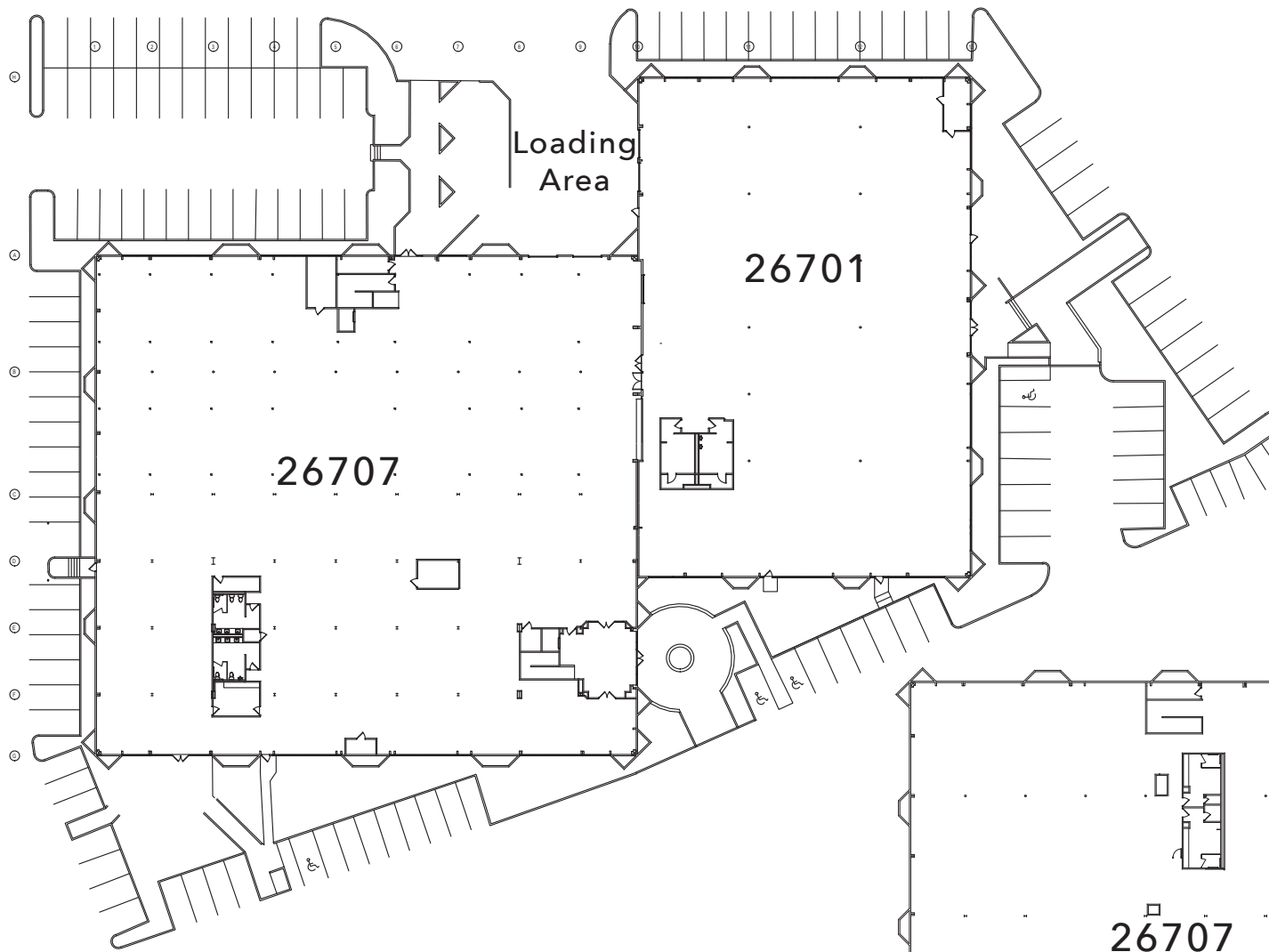

2ND FLOOR

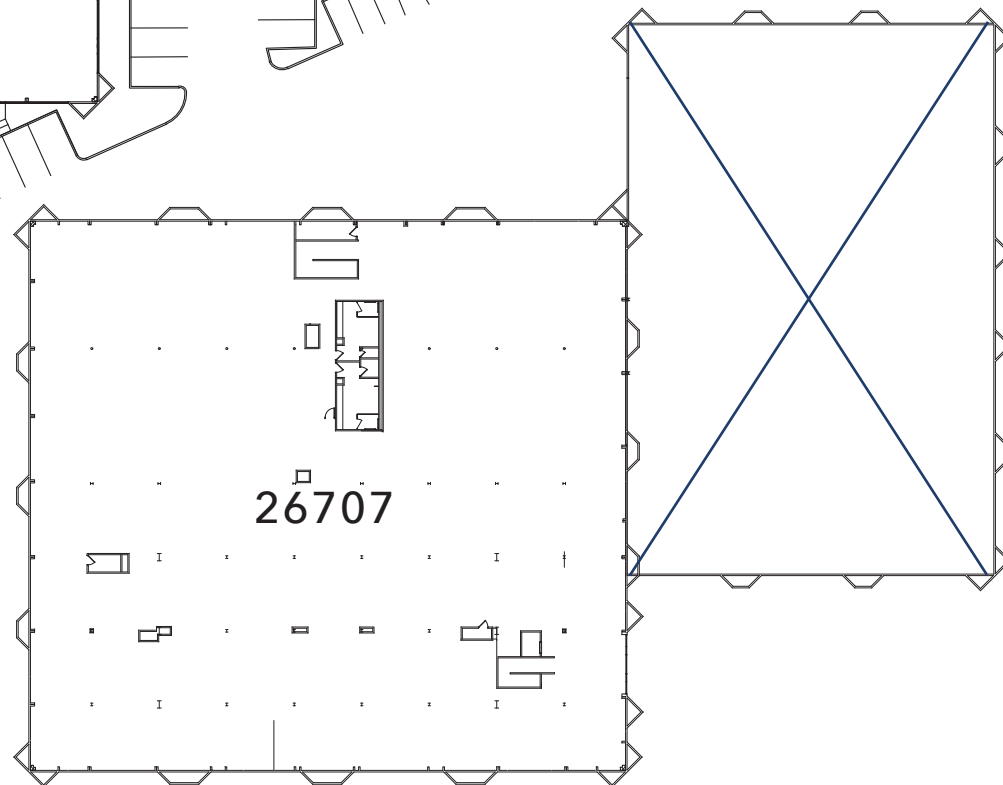

AMENITIES MAP

SUBJECT
26701-26707 Agoura Rd
Calabasas, CA

- erewhon Natural Foods Market
- universal appliance and kitchen center
- Jersey Mike's SUBS
- BCBC NAIL SPA
- Furr Saj RESTAURANT
- CosmoProf
- HOME consignment
- SUSHI NISHI calabasas
- MyDaySpa and Wellness
- Exer
- SUNPOWER

- Albertsons
- STARBUCKS COFFEE
- Jack in the box
- McDonald's
- TACO BELL
- Pharmacy
- Mobil
- XpressLube
- SHARKY'S WOODFIRE MEXICAN GRILL
- Mediterranean PITA GRILL
- Abbyson LIVING
- 7 ELEVEN
- Shell
- Chevron
- UPS The UPS Store
- Hanami
- Fantastic Sams HAIR SALON
- CAMBRIA hotels



PEPPERDINE

Horizons
SERIAL CALABASAS

Las Virgenes
Water District

Las Virgenes
Unified School District

L.A. County
Sheriff
Community
Center

Calabasas
SELF STORAGE

The Cheesecake
Factory
HEADQUARTERS

ESOTERIX
Laboratory Services

WHEELHOUSE
SERVICES

skyline
HOME LOANS

ATHAS
Capital Group

PNC
REAL ESTATE
Canon

Alcatel-Lucent

ASGN
Incorporated

Lost Hills Rd

Agoura Rd

Las Virgenes Rd

Malibu Hills Rd

US
101

US
101

US
101

Agoura Rd

UCLA Health

KILADASHI

TicketManager

HARBOR FREIGHT TOOLS CORPORATE OFFICE

KEYSIGHT

JOSÉ EBER

Edward Jones

YAMAHA

intel

YAMAHA

Sea Doo RESTAURANT

Horizons
SERIAL CALABASAS

ASGN
Incorporated

PEPPERDINE

Horizons
SERIAL CALABASAS

Las Virgenes
Water District

Las Virgenes
Unified School District

L.A. County
Sheriff
Community
Center

Calabasas
SELF STORAGE

The Cheesecake
Factory
HEADQUARTERS

ESOTERIX
Laboratory Services

WHEELHOUSE
SERVICES

skyline
HOME LOANS

ATHAS
Capital Group

PNC
REAL ESTATE
Canon

Alcatel-Lucent

ASGN
Incorporated

Lost Hills Rd

Agoura Rd

Las Virgenes Rd

US
101

US
101

US
101

Agoura Rd

UCLA Health

KILADASHI

TicketManager

HARBOR FREIGHT TOOLS CORPORATE OFFICE

KEYSIGHT

JOSÉ EBER

Edward Jones

YAMAHA

intel

YAMAHA

Sea Doo RESTAURANT

Horizons
SERIAL CALABASAS

ASGN
Incorporated

PEPPERDINE

Horizons
SERIAL CALABASAS

Las Virgenes
Water District

Las Virgenes
Unified School District

L.A. County
Sheriff
Community
Center

Calabasas
SELF STORAGE

The Cheesecake
Factory
HEADQUARTERS

ESOTERIX
Laboratory Services

WHEELHOUSE
SERVICES

skyline
HOME LOANS

ATHAS
Capital Group

PNC
REAL ESTATE
Canon

Alcatel-Lucent

ASGN
Incorporated

Lost Hills Rd

Agoura Rd

Las Virgenes Rd

US
101

US
101

US
101

Agoura Rd

UCLA Health

KILADASHI

TicketManager

HARBOR FREIGHT TOOLS CORPORATE OFFICE

KEYSIGHT

JOSÉ EBER

Edward Jones

YAMAHA

intel

YAMAHA

Sea Doo RESTAURANT

Horizons
SERIAL CALABASAS

ASGN
Incorporated

PEPPERDINE

Horizons
SERIAL CALABASAS

Las Virgenes
Water District

Las Virgenes
Unified School District

L.A. County
Sheriff
Community
Center

Calabasas
SELF STORAGE

The Cheesecake
Factory
HEADQUARTERS

ESOTERIX
Laboratory Services

WHEELHOUSE
SERVICES

skyline
HOME LOANS

ATHAS
Capital Group

PNC
REAL ESTATE
Canon

Alcatel-Lucent

ASGN
Incorporated

Lost Hills Rd

Agoura Rd

Las Virgenes Rd

26701 - 26707 AGOURA ROAD
CALABASAS, CA 91362

R&D/WAREHOUSE
FOR SUBLEASE



**LEE &
ASSOCIATES**

COMMERCIAL REAL ESTATE SERVICES

Lee & Associates® - LA North/Ventura, Inc. Corporate ID #01191898

A Member of the Lee & Associates Group of Companies

5707 Corsa Avenue, Suite 200, Westlake Village, CA 91362

P: 818-223-4388 F: 818-591-1450 www.lee-associates.com

No warranty or representation is made to the accuracy of the foregoing information. Terms of sale or lease and availability are subject to change or withdrawal without notice. CID #01191898

MICHAEL TINGUS

President

818.223.4380

mtingus@lee-re.com

www.miketingus.com

DRE# 01013724

GRANT FULKERSON, SIOR

Principal

818.304.4956

gfulkerson@lee-re.com

www.fulkerson-re.com

DRE# 01483890